

ANNEXURE 1

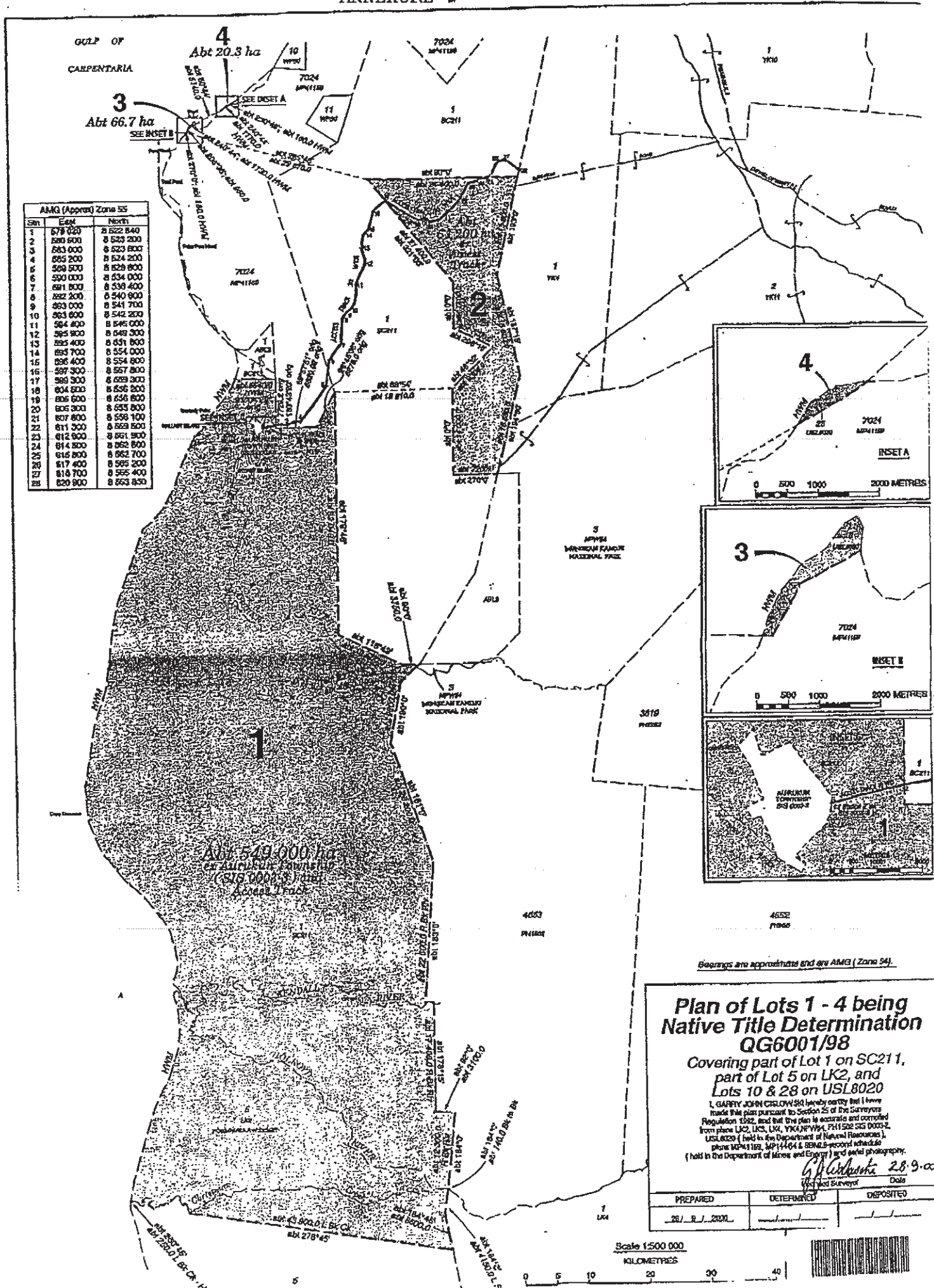

AMG (Approx) Zone 55

SN	East	North
1	679 020	8 522 840
2	580 600	8 523 200
3	583 000	8 523 600
4	685 200	8 524 200
5	598 500	8 528 800
6	500 000	8 534 000
7	681 800	8 538 400
8	582 200	8 540 900
9	583 000	8 541 700
10	583 600	8 542 200
11	584 600	8 545 000
12	585 900	8 548 300
13	587 400	8 551 800
14	589 700	8 554 000
15	596 400	8 554 800
16	599 300	8 557 200
17	598 300	8 559 300
18	604 600	8 556 200
19	606 600	8 556 600
20	606 300	8 555 800
21	607 800	8 558 100
22	611 300	8 559 500
23	612 900	8 561 900
24	614 500	8 562 800
25	616 800	8 562 700
26	617 400	8 565 200
27	616 700	8 565 400
28	620 800	8 563 800

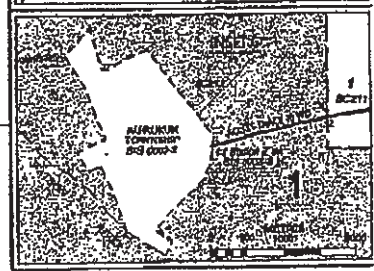
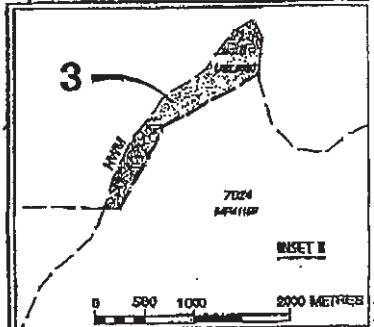
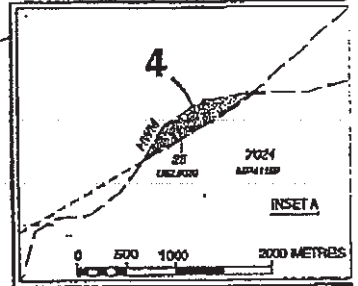

Plan of Lots 1 - 4 being Native Title Determination QG6001/98
 Covering part of Lot 1 on SC211, part of Lot 5 on LK2, and Lots 10 & 28 on USL8020

I, GARRY JOHN CLOUGH hereby certify that I have made this plan pursuant to Section 25 of the Surveyors Regulation 1982, and that the plan is accurate and compiled from plans LK2, LK3, LK4, YK4, YK5, YK6, PH1528 SG 0000-2, USL8020 (held in the Department of Natural Resources), phone MP41189, MP11404 & SBA15-second schedule (held in the Department of Mines and Energy) and aerial photography.

G. J. Clough 28.9.00
 Date

PREPARED	DETERMINED	DEPOSITED
28 / 9 / 2000	unmarked	unmarked

